

PRODUCT DATA SHEET

SPHERICAL CAP FOR TRAPEZOIDAL SHEET METALS

PRODUCT DESCRIPTION

Eurotec's spherical caps for trapezoidal sheet metals act as **sealing rings and washers** for the secure fastening of trapezoidal sheet metals. Thanks to **the integrated PE seal**, the roof itself remains **waterproof** even around the attachment points. The specially shaped spherical cap adapts perfectly to the trapezoidal sheet-metal profile and evenly distributes the pressure load, which reliably prevents the sheet metal from being dented. Thanks to the **different pre-painted colours**, the spherical caps will match your trapezoidal sheet metal perfectly and will therefore be almost invisible.



Grey white

Sienna red

ADVANTAGES / SPECIFICATIONS

- Waterproof thanks to the PE seal
- Optimum pressure distribution across the trapezoidal sheet metal
- Different sizes for all commonly available trapezoidal sheet-metal dimensions
- Different colours for all commonly available trapezoidal sheet-metal colours



Dark brown

MATERIAL

- Carbon steel pre-painted use classes 1-3, corrosion category C3
- Seal polyethylene (PE)

* On request and above a minimum order quantity, the spherical cap for trapezoidal sheet metals can also be supplied in any RAL colour.



TECHNICAL INFORMATION

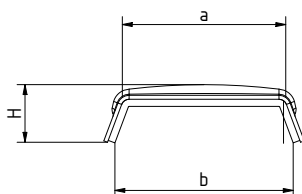

Side view

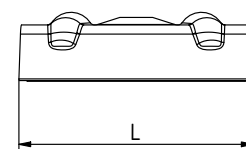

Top view

PRODUCT DATA SHEET

SPHERICAL CAP FOR TRAPEZOIDAL SHEET METALS

PRODUCT TABLE

Spherical caps for trapezoidal sheet metals						
Art. no.	Colour	Height H* [mm]	Width a* [mm]	Width b* [mm]	Length L* [mm]	PU
800570	Grey white (RAL9002)	16	15	28	50	50
800571	Grey white (RAL9002)	16	20	36	50	50
800572	Grey white (RAL9002)	16	25	34	50	50
800573	Grey white (RAL9002)	16	30	40	50	50
800574	Grey white (RAL9002)	16	40	50	50	50
800575	Sienna red (RAL3009)	16	15	28	50	50
800576	Sienna red (RAL3009)	16	20	36	50	50
800577	Sienna red (RAL3009)	16	25	34	50	50
800578	Sienna red (RAL3009)	16	30	40	50	50
800579	Sienna red (RAL3009)	16	40	50	50	50
800580	Dark brown (RAL8017)	16	15	28	50	50
800581	Dark brown (RAL8017)	16	20	36	50	50
800582	Dark brown (RAL8017)	16	25	34	50	50
800583	Dark brown (RAL8017)	16	30	40	50	50
800584	Dark brown (RAL8017)	16	40	50	50	50

* see technical drawing

COMBINABLE SCREWS

Colour caps hex bolts				
Art. no.	Colour	Spanner size	Diameter [mm]	PU
800560	Colour cap grey white (RAL9002)	10	23	500
800561	Colour cap sienna-red (RAL 3009)	10	23	500
800562	Colour cap dark brown (RAL8017)	10	23	500

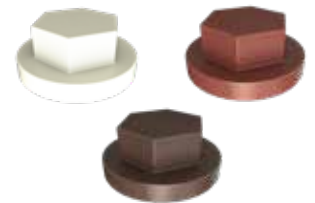

SUITABLE SCREWS

7504-K self-drilling screw		
Art. no.	Designation	PU
800550	BSK 6,3 x 60	100
800551	BSK 6,3 x 70	100
800552	BSK 6,3 x 80	100
800553	BSK 6,3 x 100	100
800554	BSK 6,3 x 120	100
800555	BSK 6,3 x 140	100
800556	BSK 6,3 x 160	100
800557	BSK 6,3 x 180	100
800558	BSK 6,3 x 200	100



PRODUCT DATA SHEET

SPHERICAL CAP FOR TRAPEZOIDAL SHEET METALS

SUITABLE SCREWS

Wood connection:

Panelwistec AG, flange button head screws, hardened stainless steel			
Art. no.	Dimension ^{ø1} [mm]	Drive	PU
975772	6,0 x 60	TX30 •	100
975773	6,0 x 80	TX30 •	100
975774	6,0 x 100	TX30 •	100
975775	6,0 x 120	TX30 •	100
975776	6,0 x 140	TX30 •	100
975777	6,0 x 160	TX30 •	100

Panelwistec AG, flange button head TX40			
Art. no.	Dimension ^{ø1} [mm]	Drive	PU
945713-TX40	6,0 x 60	TX40 •	100
945717-TX40	6,0 x 80	TX40 •	100
945719-TX40	6,0 x 100	TX40 •	100
945721-TX40	6,0 x 120	TX40 •	100
945723-TX40	6,0 x 140	TX40 •	100
945725-TX40	6,0 x 160	TX40 •	100
945726-TX40	6,0 x 180	TX40 •	100
945727-TX40	6,0 x 200	TX40 •	100
945728-TX40	6,0 x 220	TX40 •	100
945729-TX40	6,0 x 240	TX40 •	100

Panelwistec AG, flange button head screw			
Art. no.	Dimension ^{ø1} [mm]	Drive	PU
945713	6,0 x 60	TX30 •	100
945716	6,0 x 70	TX30 •	100
945717	6,0 x 80	TX30 •	100
945718	6,0 x 90	TX30 •	100
945719	6,0 x 100	TX30 •	100
945720	6,0 x 110	TX30 •	100
945721	6,0 x 120	TX30 •	100
945722	6,0 x 130	TX30 •	100
945723	6,0 x 140	TX30 •	100
945724	6,0 x 150	TX30 •	100
945725	6,0 x 160	TX30 •	100
945726	6,0 x 180	TX30 •	100
945727	6,0 x 200	TX30 •	100
945728	6,0 x 220	TX30 •	100
945729	6,0 x 240	TX30 •	100
945730	6,0 x 260	TX30 •	100
945731	6,0 x 280	TX30 •	100
945732	6,0 x 300	TX30 •	100



NKL 1-3



NKL 1-2



NKL 1-2

PRODUCT DATA SHEET

SPHERICAL CAP FOR TRAPEZOIDAL SHEET METALS

SUITABLE SCREWS

SWPS bimetal				
Art. no.	Dimension ^ø [mm]	Thread length [mm]	Ø-Sealing disc [mm]	PU
945839	6,5 x 120	72	16	200
945915	6,5 x 140	72	16	200
945916	6,5 x 160	72	16	200
945917	6,5 x 180	72	16	200
945918	6,5 x 200	72	16	200



NKL 1 – 3

If you are not familiar with how this product is used, and particularly with the product's intended use, please contact our Application Technology department (Technik@eurotec.team).