

PRODUCT DATA SHEET

ROPE LOOP

PRODUCT DESCRIPTION

The rope loop for drive-in nuts is a durable fastening element made of high-quality, corrosion-resistant steel. It is characterised by a high tensile strength and ensures safe load handling even under high loads. Installation is quick and uncomplicated, as it is compatible with many common drive-in nuts. Particularly in the construction industry, the rope loop is ideal for applications where long-term stability and reliable fastenings are required.

ADVANTAGES / SPECIFICATIONS

- **Easy to install:** Quick and easy to install thanks to the metric thread.
- **Compatibility:** Fits M12 & M16
- The maximum load capacity is clearly stated, so that users can be sure to choose the right rope loop for their specific applications.
- **Use:** Multiple use is possible (*after testing*)



PRODUCT TABLE

Rope loop					
Art. no.	Load class [t]	Height [mm]	Thread [dxh]	Weight [kg]	PU
111423	0,5	500	M12 x 22	0,164	1
111424	1,2	500	M16 x 27	0,313	1

PRODUCT DATA SHEET

ROPE LOOP

TECHNICAL INFORMATION

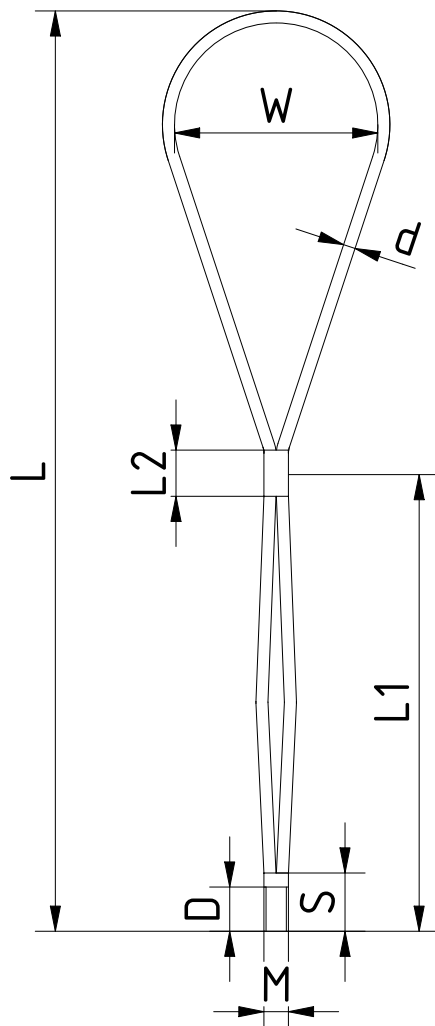

Side view

Rope loop							
Dimensions	M	D [mm]	d [mm]	L [mm]	L1 [mm]	L2 [mm]	W [mm]
M12 x 22 mm/0,5 t/500 mm	M12	22	6	500	250	23	119
M16 x 27 mm/1,2 t/500 mm	M16	27	8	500	250	32	116

If you are not familiar with how this product is used, and particularly with the product's intended use, please contact our Application Technology department (Technik@eurotec.team).