

PRODUCT DATA SHEET

SCREW-IN ROD

PRODUCT DESCRIPTION

The screw-in rod is a sturdy hand tool designed for manually screwing in 60-series screw foundations. The bent end is inserted into the cross hole of the foundation and serves as a pivot point. The long rod section provides effective leverage and ensures precise, controlled installation even without mechanical assistance.

SPECIFICATIONS

- For manually driving screw foundations (60 series)
- Angled end for insertion into the cross hole
- Longer rod section for better leverage
- The foundation is anchored in the ground through uniform rotational movements
- The ribbed profile ensures a secure grip and controlled handling

MATERIAL

- Galvanized, corrugated steel



PRODUCT TABLE

Length [mm]	Diameter [mm]	Weight [kg]	PU
1000	Ø 16	1,33	1

PRODUCT DATA SHEET

SCREW-IN ROD

TECHNICAL INFORMATION

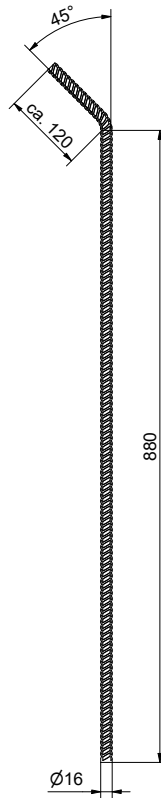

If you are unfamiliar with the application of this product, particularly its intended use, please be sure to contact our Application Engineering department (technik@eurotec.team).