

# PRODUCT DATA SHEET

## LOAD BRACKET

### PRODUCT DESCRIPTION

Especially when **using lightweight terrace decking** like WPC boards, **bending and warping** can occur due to waterlogging or heat build-up. With the help of our load bracket, additional loads in the form of e.g. heavy stone slabs can be added within the **substructure to counteract potential warping**.



### ADVANTAGES

- Prevents potential deformation or warping of the terrace
- Helps to secure the terrace's position
- Compatible with our EVO system profile and our HKP support system

### MATERIAL

- Aluminium

### IMAGES OF APPLICATIONS



The load bracket can be flexibly attached along the length of the aluminium profile and is fastened laterally with 2 BiGHTY screws.

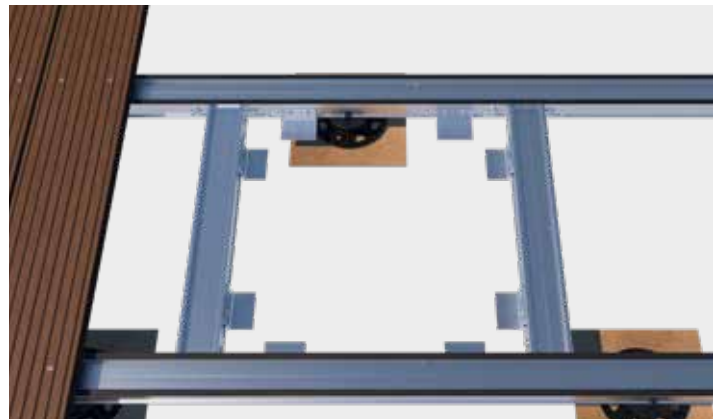

The required number of load brackets varies with the size of the selected stone slab.

# PRODUCT DATA SHEET

# LOAD BRACKET



## NOTE

Always include at least 4 brackets per stone! Each Load bracket comes with two 4.8 x 25 mm BiGHTY drilling screws for fastening to the profiles.

The inserted stone disappears completely between the aluminium substructure and is no longer visible when the terrace is finished.

## PRODUCT TABLE

Art.-No.	Product description	Dimensions <sup>a)</sup> [mm]	PU
945061	Load bracket	40 x 60 x 40	10

<sup>a)</sup>Height x width x depth

## DRAWINGS

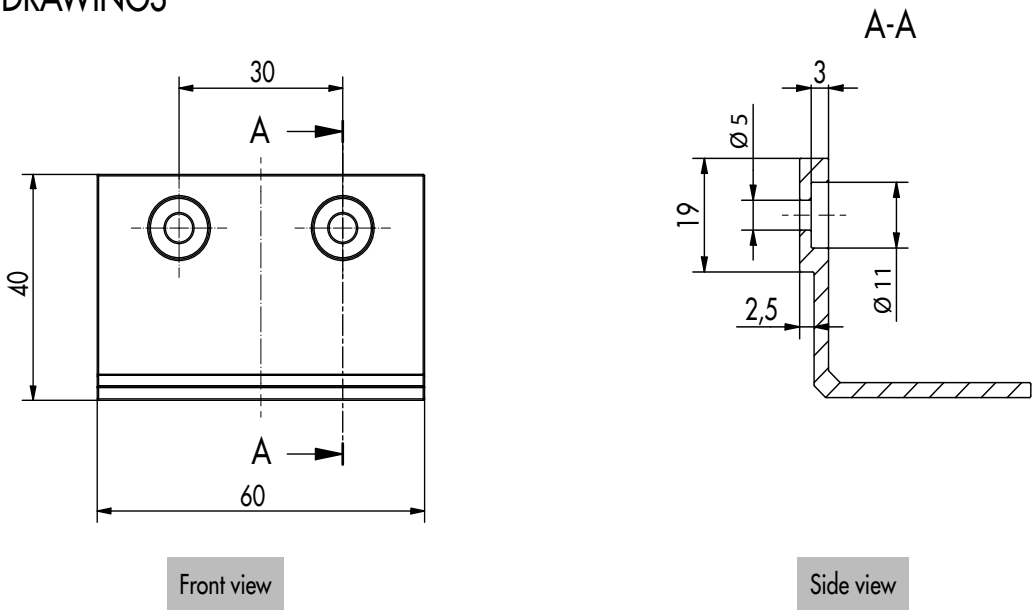

If you are not familiar with how this product is used, and particularly with the product's intended use, please contact our Application Technology department (technik@eurotec.team).